

NOTES:
DO NOT SCALE FROM DRAWING.
DIMENSIONS ARE IN MILLIMETRES.

ALL NON-BARRACUDA SYSTEM
COMPONENTS ARE INTENDED TO BE
'INDICATIVE' ONLY.

'COMPRESSIBLE JOINTS' ARE SHOWN
WITH A TYPICAL INDICATIVE WIDTH
OF 10mm. THE ACTUAL JOINT WIDTH
USED, MUST BE ADEQUATE TO
ACCOMMODATE ALL BUILDING
MOVEMENTS THAT MIGHT OCCUR AT
THAT JOINT LOCATION.

THE 'MOVEMENT JOINTS' ARE USUALLY
FILLED WITH A POLYETHYLENE
BACKING ROD AND LOW MODULUS
SILICONE SEALANT.

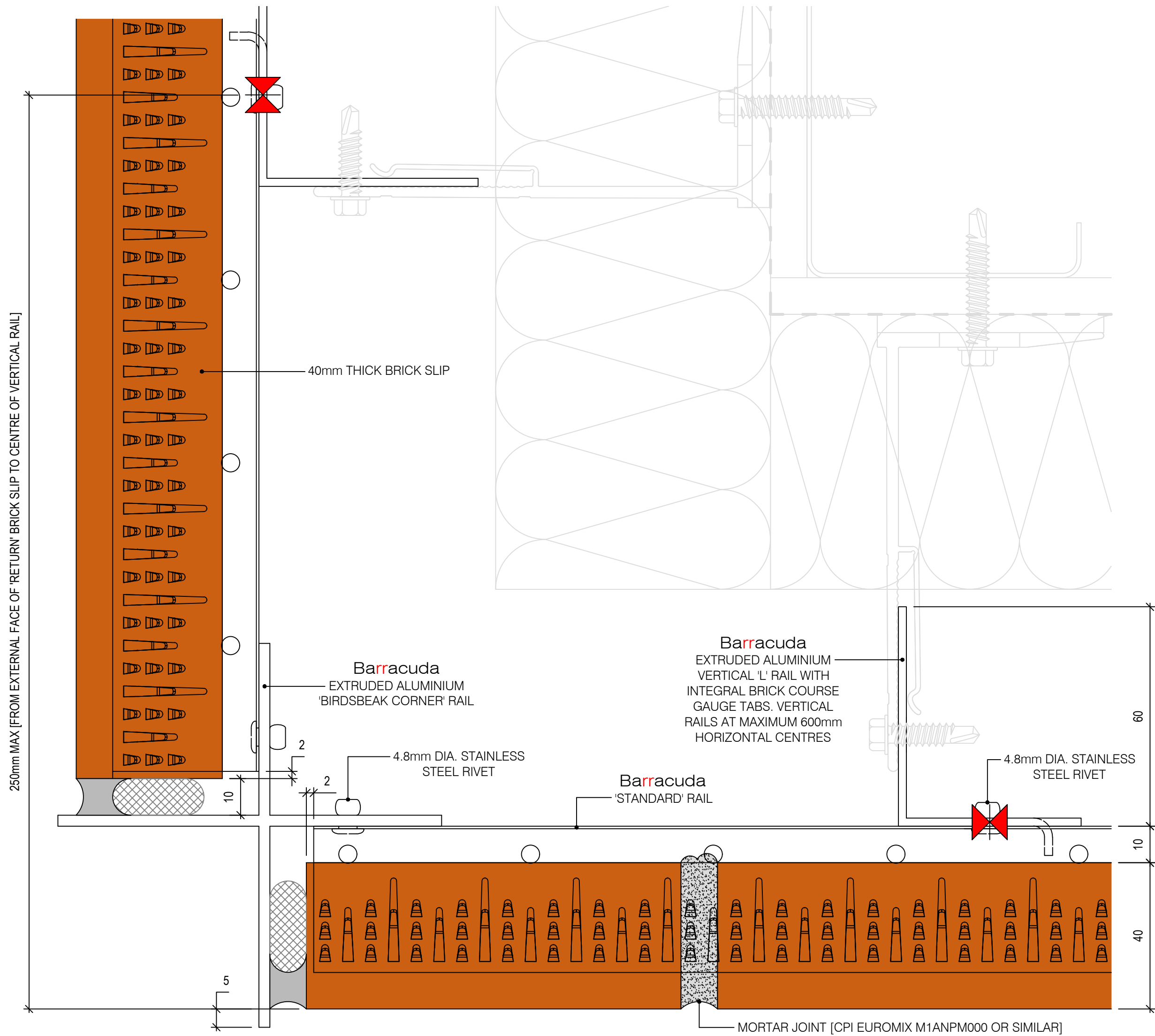

01	FIRST ISSUE	JSC	12/12/2022
REV:	REVISION DETAIL:	CHKD:	DATE:
Barracuda			
BRICK SLIP SUPPORT SYSTEM			
TYPICAL DETAIL			
TITLE: PLAN [EXTERNAL 90 DEGREE CORNER WITH 'BIRDSBEAK' ALUMINIUM CORNER TRIM]			
DATE: 12/12/2022			<div></div>
SCALE: 1:1		PLOT SIZE: A3	
DRAWING NUMBER: TD-B-116		REVISION: 01	